

Patient Instructions for Assisted Saliva Collection REF GFXA-01  
**USING FOAM SWABS**

**Collection Precautions:**

- Do not eat, drink, smoke, brush your teeth or chew gum for 30 minutes before use.
- Do not leave the donor unattended during the sample collection.
- Ensure the donor is in an upright position during the sample collection.
- Check the swabs for any signs of damage before use - **DO NOT** use if the foam swab head appears damaged.

**Warnings: Do not swallow.** If the stabilising solution comes into contact with the skin or eyes, wash with plenty of water. Tube cap and bag containing the foam swabs may be a choking hazard to small children. MSDS available at [www.isohelix.com](http://www.isohelix.com)

**Kit Contents:** Sample tube with 1ml stabilising solution, funnel and 2 foam tipped swabs.

**GeneFix™ Assisted Saliva Collectors** are intended for the collection of human saliva samples for DNA stabilisation.

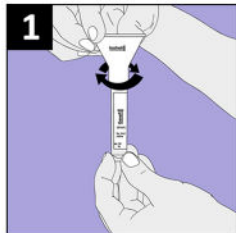

1. Remove the collection funnel and tube from the pack. Remove the foam swabs from their wrappers. Unscrew the cap from the tube being careful not to spill the liquid. Keep the cap for use later. Screw the collection funnel on to the tube gently. **Do not over-tighten.**



2. Make sure the donor is sitting in an upright position. Gently move the swab around the front area of the mouth and under the tongue to take up as much saliva as possible until the swab head is completely wet. **DO NOT - Chew the swab, attempt to pull the swab head from the shaft or use towards the back of the mouth**



3. Squeeze the swab head against the side of the funnel in a rotating movement to remove the saliva. Once saliva is removed, using the same swab repeat steps 2 and 3 multiple times until the level collected in the tube reaches the **2ml Fill To** ➡ line. If the swab shows signs of wear and tear, use the second swab provided. **DO NOT re-use a swab if it has come into contact with the buffer or has been pushed through the funnel tube.**

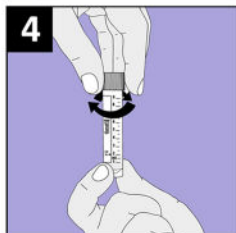

4. Unscrew the collection funnel and replace the tube cap tightly. Discard the funnel. Shake the collection tube several times to mix the saliva with the solution.

**For Laboratory Processing:**  
 Proteinase K will be required for lysis. Visit [www.isohelix.com](http://www.isohelix.com) for further information.

Patient Instructions for Assisted Saliva Collection REF GFXA-01  
**USING FOAM SWABS**

**Collection Precautions:**

- Do not eat, drink, smoke, brush your teeth or chew gum for 30 minutes before use.
- Do not leave the donor unattended during the sample collection.
- Ensure the donor is in an upright position during the sample collection.
- Check the swabs for any signs of damage before use - **DO NOT** use if the foam swab head appears damaged.

**Warnings: Do not swallow.** If the stabilising solution comes into contact with the skin or eyes, wash with plenty of water. Tube cap and bag containing the foam swabs may be a choking hazard to small children. MSDS available at [www.isohelix.com](http://www.isohelix.com)

**Kit Contents:** Sample tube with 1ml stabilising solution, funnel and 2 foam tipped swabs.

**GeneFix™ Assisted Saliva Collectors** are intended for the collection of human saliva samples for DNA stabilisation.

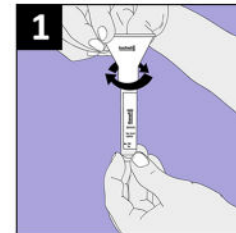

1. Remove the collection funnel and tube from the pack. Remove the foam swabs from their wrappers. Unscrew the cap from the tube being careful not to spill the liquid. Keep the cap for use later. Screw the collection funnel on to the tube gently. **Do not over-tighten.**

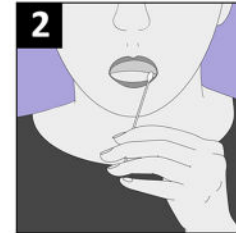

2. Make sure the donor is sitting in an upright position. Gently move the swab around the front area of the mouth and under the tongue to take up as much saliva as possible until the swab head is completely wet. **DO NOT - Chew the swab, attempt to pull the swab head from the shaft or use towards the back of the mouth**

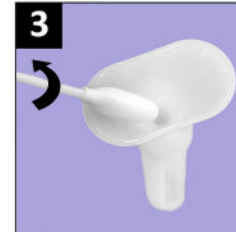

3. Squeeze the swab head against the side of the funnel in a rotating movement to remove the saliva. Once saliva is removed, using the same swab repeat steps 2 and 3 multiple times until the level collected in the tube reaches the **2ml Fill To** ➡ line. If the swab shows signs of wear and tear, use the second swab provided. **DO NOT re-use a swab if it has come into contact with the buffer or has been pushed through the funnel tube.**

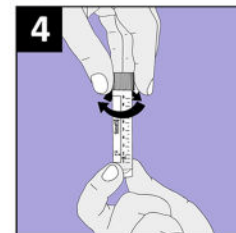

4. Unscrew the collection funnel and replace the tube cap tightly. Discard the funnel. Shake the collection tube several times to mix the saliva with the solution.

**For Laboratory Processing:**  
 Proteinase K will be required for lysis. Visit [www.isohelix.com](http://www.isohelix.com) for further information.